

Illustrated Index

Torque Converter Housing/Valve Body

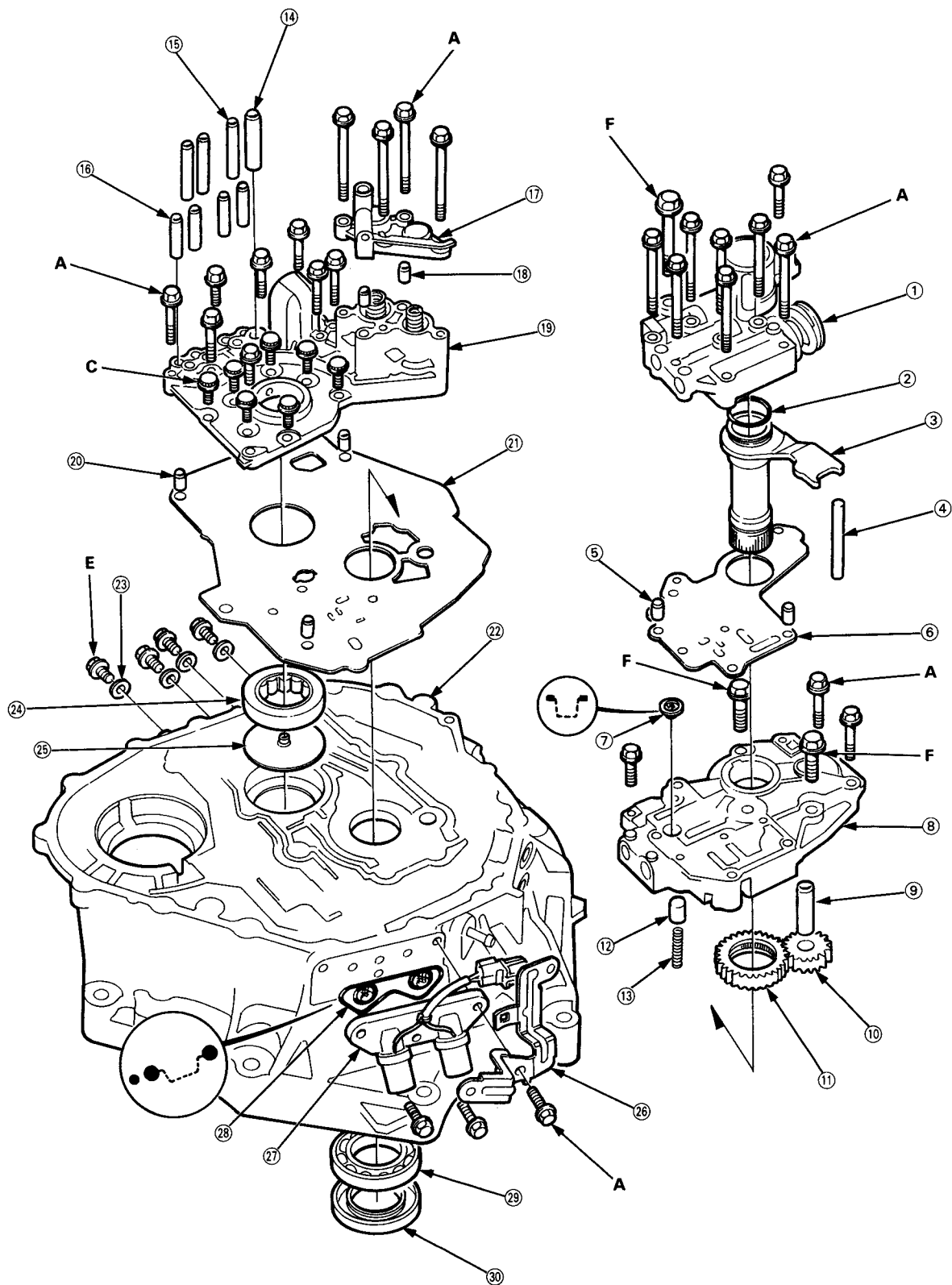



- ① REGULATOR VALVE BODY
- ② O-RING Replace.
- ③ STATOR SHAFT
- ④ STOPPER SHAFT
- ⑤ DOWEL PIN
- ⑥ REGULATOR SEPARATOR PLATE
- ⑦ OIL PUMP BODY FILTER Replace.
- ⑧ OIL PUMP BODY
- ⑨ OIL PUMP DRIVEN GEAR SHAFT
- ⑩ OIL PUMP DRIVEN GEAR
- ⑪ OIL PUMP DRIVE GEAR
- ⑫ TORQUE CONVERTER CHECK VALVE
- ⑬ TORQUE CONVERTER CHECK VALVE SPRING
- ⑭ OIL PIPE, 10 x 60 mm
- ⑮ OIL PIPE, 8 x 57.5 mm
- ⑯ OIL PIPE, 8 x 40 mm
- ⑰ ACCUMULATOR COVER
- ⑱ DOWEL PIN
- ⑲ ACCUMULATOR BODY
- ⑳ DOWEL PIN
- ㉑ ACCUMULATOR BODY SEPARATOR PLATE
- ㉒ TORQUE CONVERTER HOUSING
- ㉓ SEALING WASHER Replace.
- ㉔ TORQUE CONVERTER HOUSING COUNTERSHAFT BEARING
- ㉕ OIL GUIDE PLATE
- ㉖ LOCK-UP CONTROL SOLENOID VALVE CONNECTOR STAY
- ㉗ LOCK-UP CONTROL SOLENOID VALVE ASSEMBLY
- ㉘ LOCK-UP CONTROL SOLENOID FILTER/GASKET Replace.
- ㉙ TORQUE CONVERTER HOUSING MAINSHAFT BEARING
- ㉚ MAINSHAFT OIL SEAL Replace.

TORQUE SPECIFICATIONS

No.	Torque Value	Bolt Size	Remarks
A	12 N·m (1.2 kg-m, 9 lb-ft)	6 x 1.0 mm	Special Bolt Oil Pressure Check Bolt
C	12 N·m (1.2 kg-m, 9 lb-ft)	6 x 1.0 mm	
E	18 N·m (1.8 kg-m, 13 lb-ft)	8 x 1.25 mm	
F	18 N·m (1.8 kg-m, 13 lb-ft)	8 x 1.25 mm	